

Copyright Rolfe Judd Ltd

NOTES

- 1 The Contractor must check and confirm all dimensions
- 2 All discrepancies must be reported and resolved by the Architect before works commence
- 3 This drawing is not to be scaled
- 4 All work and materials to be in accordance with current applicable Statutory Legislation and to comply with all relevant Codes of Practice and British Standards

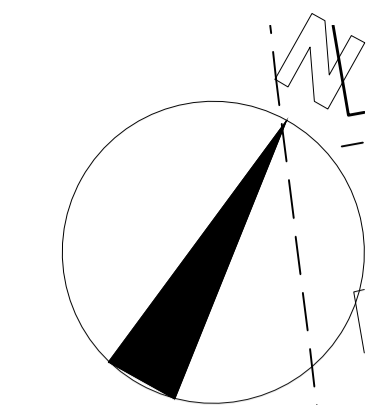

Application Boundary

Office Car Space  
Residential Car Space  
WRAC Car Space  
Curchods Car Space

Studio  
1 Bed  
2 Bed  
3 Bed

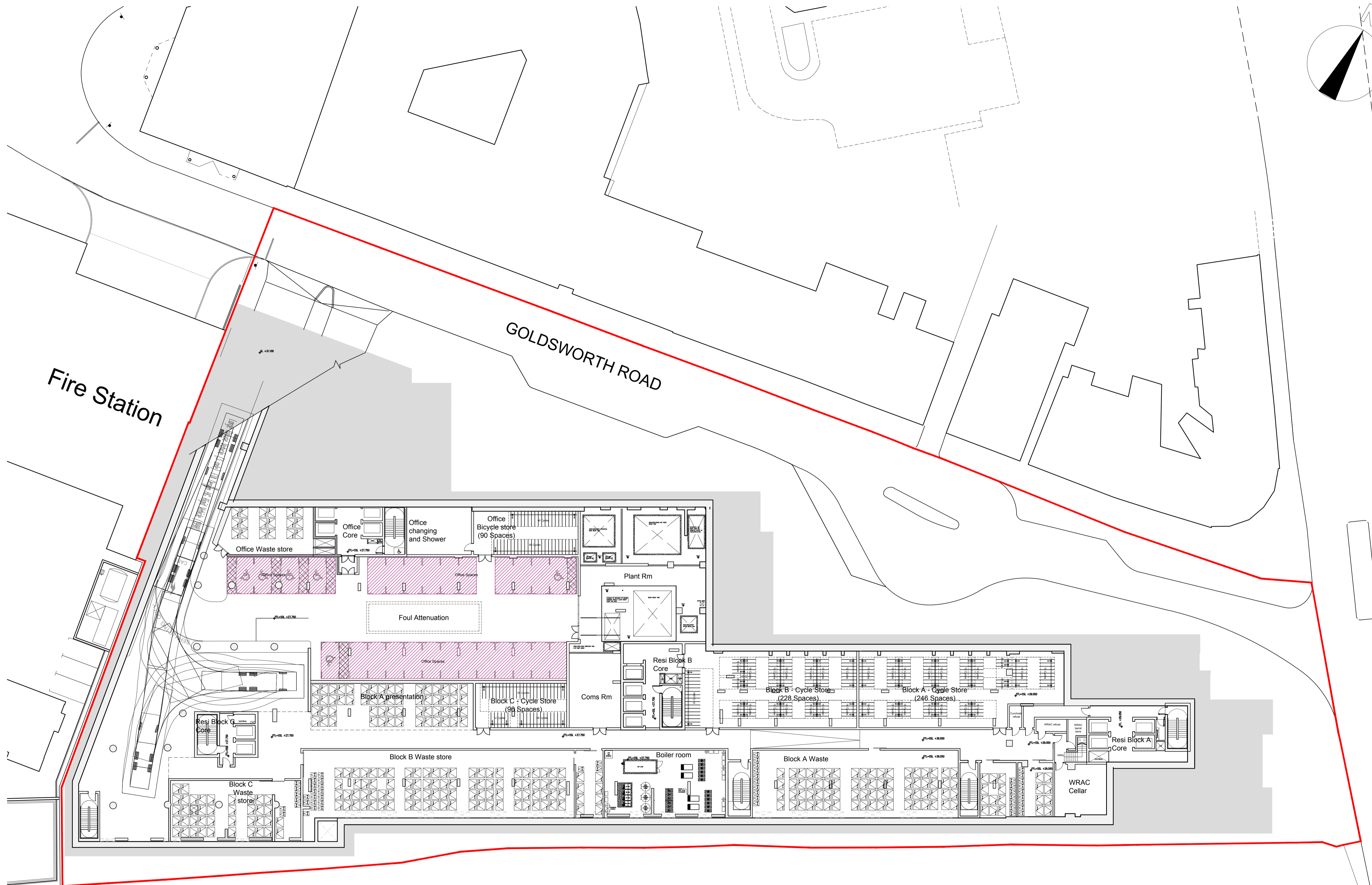

C Planning issue. 24/06/16  
B Kerb line and legend added. Plant added in Rev. A. 22/06/16  
A WRAC cellar, curchords bin store 14/06/16  
- Planning drawings issued for Client's review. 03/06/16

Rev \_\_\_\_\_ Date \_\_\_\_\_

**Rolfe Judd**  
Architecture Planning Interiors  
Old Church Court, Claylands Road, The Oval, London SW8 1NZ  
T 020 7556 1500  
www.rolfe-judd.co.uk

Client  
Goldsworth Road Development LLP

Project  
Goldsworth Road (South)  
20-32 Goldsworth Road, Woking

Drawing  
Site Wide Plan  
Level -1  
Basement

Scale Date Status  
1:250 (A1) June 16 Planning

Job Number Drawing Number Revision  
5712 T(20)P-1 C

G:\5712T\_SeriesT20T20P-1

This scale is 10mm in length when printed at the size indicated in the title block

