

KEY

- STUDIO APARTMENT
- 1 BEDROOM APARTMENT
- 1 BEDROOM DUPLEX / TOWNHOUSE
- 2 BEDROOM APARTMENT
- 2 BEDROOM TOWNHOUSE
- 2 BEDROOM UPPER DUPLEX
- 2 BEDROOM LOWER DUPLEX
- 3 BEDROOM APARTMENT / TOWNHOUSE

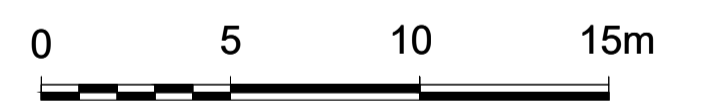
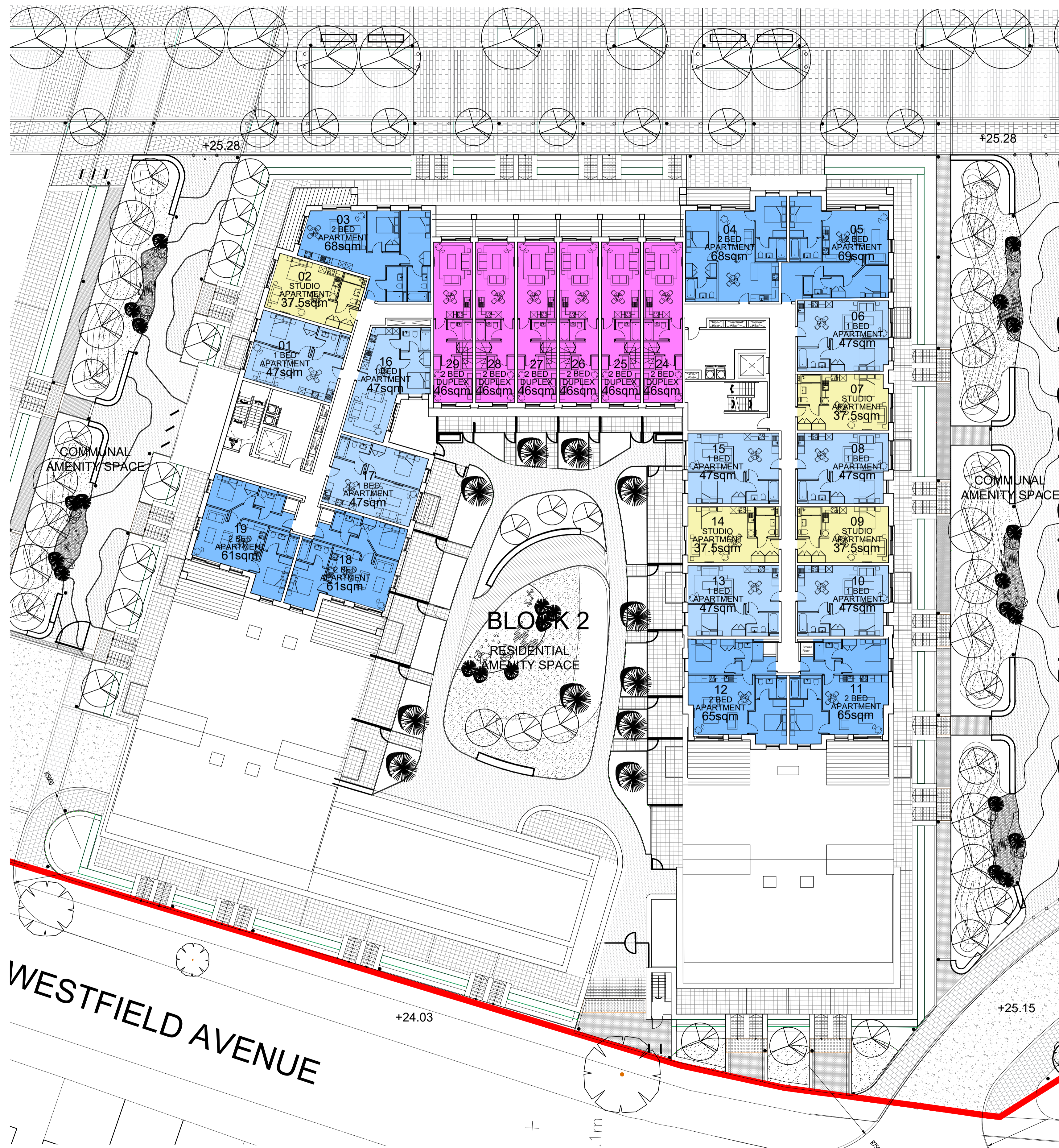
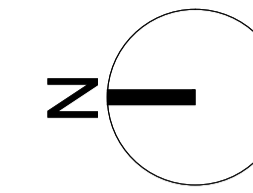

SCALE @ 1:200

rev	description	drawn	auth	date

© LEACH RHODES WALKER 2001

LeachRhodesWalker
Architects

info@lrw.co.uk | www.lrw.co.uk
50 Dearmans Place Manchester M3 5LH

Manchester London Bucharest
+44 (0)161 833 0211 +44 (0)207 993 1363 +40 (21)650 4026

client WOKING FOOTBALL CLUB		
project CARDINAL COURT INC. WOKING FOOTBALL CLUB		
project no 7884	drawing no L(00)131	rev G
description Block 2 Seventh Floor Plan		
scale 1:200@ A1	date drawn 22.10.19	drawn by KHW
		authorised by CJG
purpose of issue planning <input checked="" type="checkbox"/> building regs <input type="checkbox"/> tender <input type="checkbox"/> comment <input type="checkbox"/> approval <input type="checkbox"/> construction <input type="checkbox"/>		

WESTFIELD AVENUE